

4

3

2

1

PARTS LIST

| ITEM | QTY | PART NUMBER | DESCRIPTION |
|------|-----|-------------|------------------------------------|
| 1 | 1 | 7100-0530 | Strut Tube (35.375) |
| 2 | 1 | 7000-4010 | Tube End Fitting .5-20 |
| 3 | 1 | CMR8 QA-1 | 1/2"-20 Rod End Bearing |
| 4 | 1 | 1/2 - 20 | Hex Jam Nut |
| 5 | 1 | 7100-1060 | Spring Strut Base |
| 6 | 1 | 7100-0490 | Spring Strut Cap |
| 7 | 1 | 9584K920 | 2" OD x 1" ID x 3" Red Die Spring |
| 8 | 1 | 90133A440 | 1 x 2 x .125 Return Cushion Washer |
| 9 | 1 | AN4-13A | 1/4"-28 x 1 3/8" |
| 10 | 2 | AN4-16A | 1/4"-28 x 1 3/4" |
| 11 | 3 | MS21042-4 | 1/4"-28 Stop Nut |
| 12 | 6 | AN960-416 | 1/4" Flat Washer x .062" |

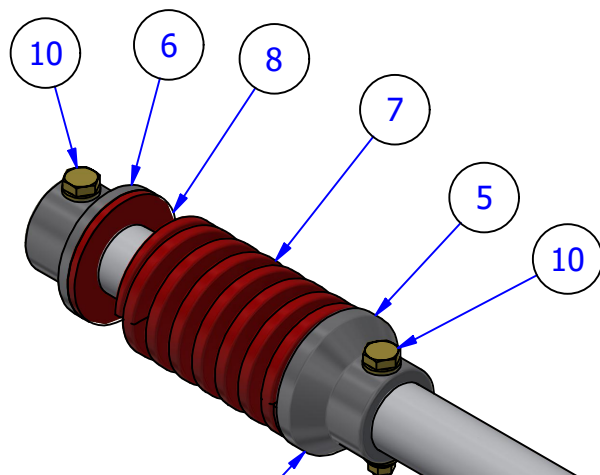

Thicker Collar Goes Here

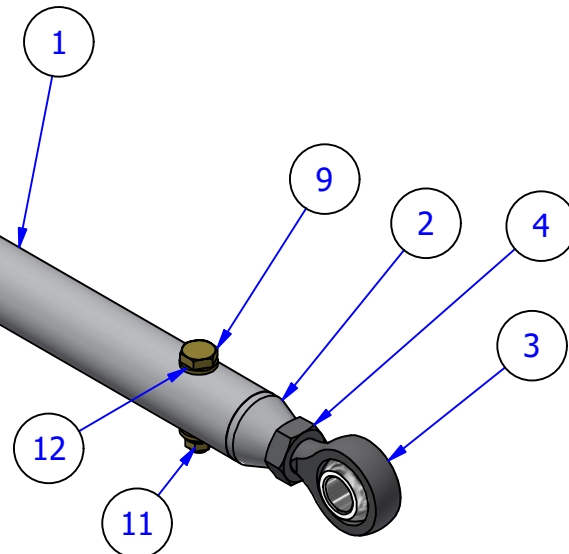

PART NAME:
Strut Spring Assy

PART NUMBER:
Strut Spring Assy



31196 490th Street, Kasota, MN 56050
 507-243-3991
 sales@gyrotech.com www.gyrotech.com

THIS DRAWING AND THE INFORMATION HEREIN IS THE EXCLUSIVE PROPERTY OF GYRO TECHNIC INC AND IS NOT TO BE REPRODUCED OR USED TO MANUFACTURE ITEMS FOR USE OR SALE BY ANY OTHER PERSON OR CONCERN WITHOUT THE WRITTEN PERMISSION OF GYRO TECHNIC INC.

4

3

2

1