

4

3

2

1

PARTS LIST

PARTS LIST

ITEM	QTY	PART NUMBER	DESCRIPTION
28	13	MS21042-4	1/4"-28 Stop Nut
29	20	AN960-416	1/4" Flat Washer x .062"
30	6	AN960-416L	1/4" Flat Washer x .031"

ITEM	QTY	PART NUMBER	DESCRIPTION
1	1	7100-4880	PR Seat Frame Mount Plate
2	1	7100-4870	Collective Pivot Tube
3	1	7100-6950	Collective Tube_Quadrant
4	1	7100-6960	Grip Insert_Quadrant
5	1	7100-4830	Collective Knuckle Top Plate
6	1	7100-4840	Collective Knuckle Bottom Plate
7	1	7100-4810	PR_Cable Pull Arm
8	1	7100-4800	PR Spacer A
9	1	7100-4790	PR Safety Catch
10	1	7100-9090	Mount Angle_Collective
11	1	875 Grip	7/8" ID Grip
12	2	GFI-1214-08	.750" x .875" x .500" OAL
13	1	7100-4820	Vinyl Cushion_PR
14	1	7100-4850	Collective Stop Pin
15	1	7100-5270	Safety Catch Spacer
16	1	7100-6150	PR Cable Attachment Barrel
17	1	61095K320	1/4"-20 BLACK POLY BALL KNOB
18	1	9654K126	1.5" x .312" x .036" - PR Lock Spring
19	1	1/4 - 20 UNC - 1/2 SHCS	Hexagon Socket Head Cap Screw
20	1	92373A245	Spring Pin 3/16 x 1/2
21	2	10 - 24 UNC - 5/8 SHCS	Hexagon Socket Head Cap Screw
22	1	10 - 24	Hex Machine Screw Nut
23	2	AN4-6A	1/4"-28 x 3/4"
24	6	AN4-14A	1/4"-28 x 1 1/2"
25	2	AN4-15A	1/4"-28 x 1 5/8"
26	1	AN4-20A	1/4"-28 x 2"
27	2	AN4-24A	1/4"-28 x 2 1/2"

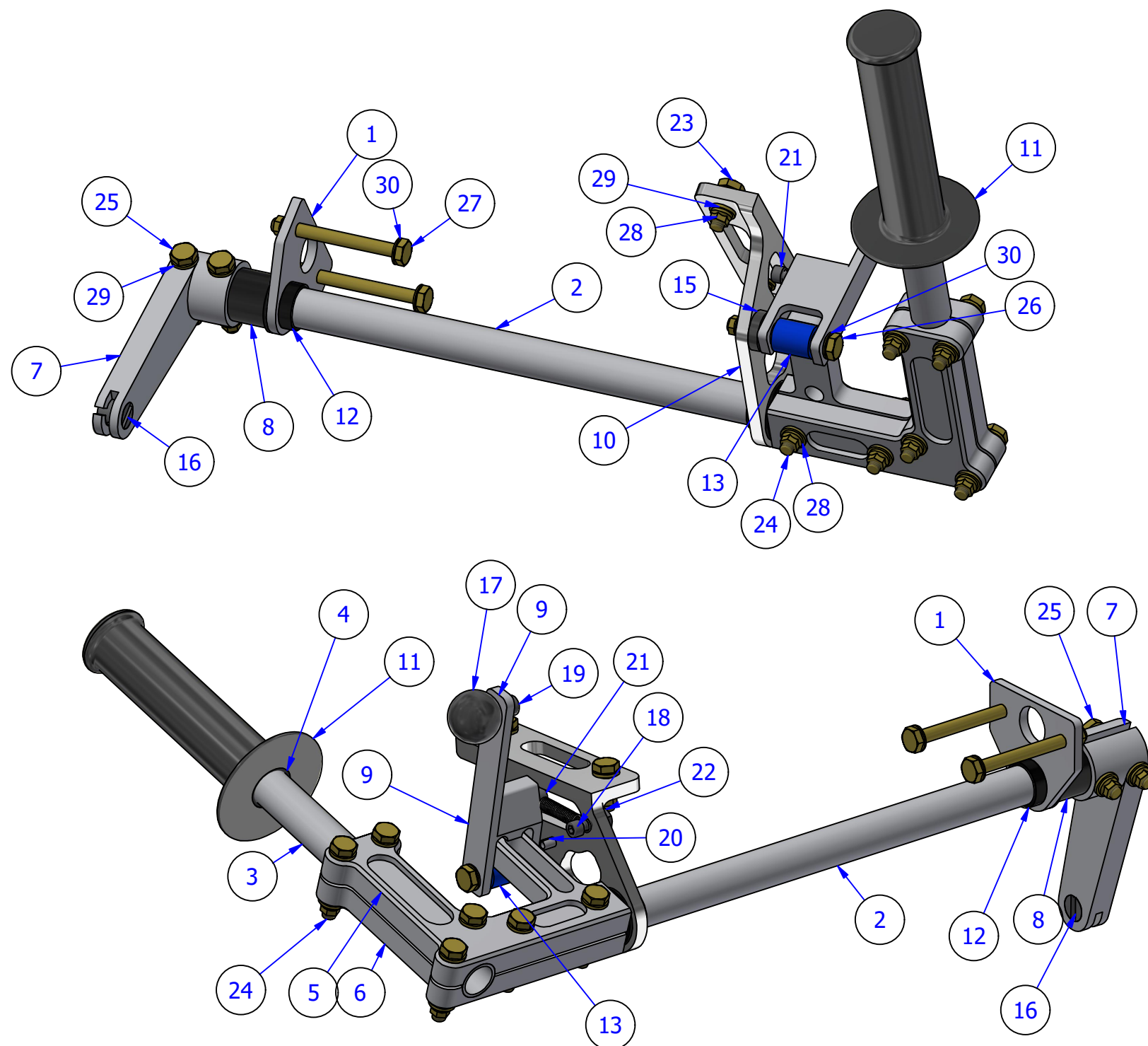

PART NAME:
Collective Sub Assy

PART NUMBER:



GYRO TECHNIC
engineering the power of flight

31196 490th Street, Kasota, MN 56050
507-243-3991
sales@gyrotechinc.com www.gyrotechinc.com

THIS DRAWING AND THE INFORMATION HEREIN IS THE EXCLUSIVE PROPERTY OF GYRO TECHNIC INC AND IS NOT TO BE REPRODUCED OR USED TO MANUFACTURE ITEMS FOR USE OR SALE BY ANY OTHER PERSON OR CONCERN WITHOUT THE WRITTEN PERMISSION OF GYRO TECHNIC INC.

4

3

2

1